



# CHERRYWAY II

HANDLING  
GRADING  
PACKING



# CHERRYWAY II



## Machine description / Working principle:

The Cherryway II is the solution brought by our engineers so that small fruits can benefit of an adequate grading that guarantees their good packing:

- It is composed of a Vee-belt, a recycling belt of the doubled fruits, a bicone conveyor and a fruit ejection system by pulsed air.
- The GLOBALSCAN 6 CHERRY program analyzes color, diameter, shape, external and internal quality. ORPHEA program controls the outlet of destination according to the criteria of selection.
- The fruit is expelled by pulsed air towards a motorized belt which feeds directly to either a packing station which can be manual or automatic, or to a water channel.
- A wide range of box fillers and punnet fillers are adaptable on the grader outlets



## Advantages :

- The fastest grader on the market
- Stainless steel frame
- Possibility to integrate various pre-packing machines (box fillers and punnet fillers)
- Reduced product handling
- Emptying regulation to ensure an optimal filling percentage (Optional)
- 4 Vee-belt in cascade

## Characteristics CW II :

- Dimensions: available in 1, 2, 4, 6, 8, 10 and up to 14 lane on special request
- Energy consumption:
  - Air: 25 Nm<sup>3</sup>/hour/line;
  - Air pressure: 8 bars;
  - Electricity : 5,75CV/7,75CV depending of the length and number of lines
- Grader with a 38.10mm pitch
- Working speed: 1800 bicones/minute/line
- Aimed at little round or elongated fruit with a maximum diameter of 40mm like cherries or cherry tomatoes.

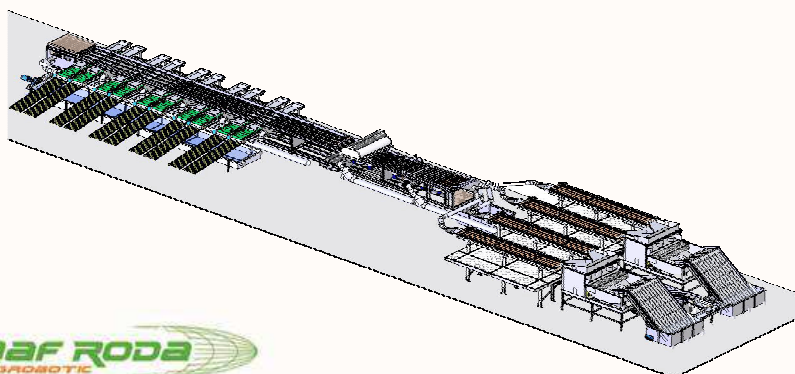

## Head office:

MAF Agrobotic  
 Impasse d'Athènes  
 ZAC Albasud II, CS 60112  
 82001 Montauban, France  
 Tel: +33(0)563632770  
 Fax: +33(0)563630785  
 e-mail: maf@maf-france.com